

CILINDRI CON RITORNO A MOLLA SIA A SPINGERE CHE A TIRARE CYLINDERS WITH SPRING REVERSAL FOR PUSHING AND PULLING

MT 200

Cod.MBA52
Cod.MBA5210T

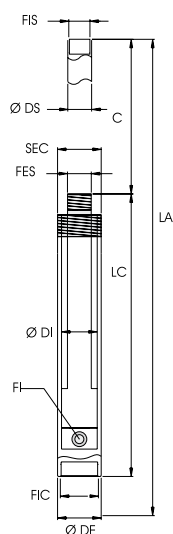

POTENZA (TON.) POWER	6
POTENZA (LB) POWER	13227
PRESSIONE (BAR) PRESSURE	700
PRESSIONE (PSI) PRESSURE	10150
CAPACITÀ OLIO (CM ³) OIL TANK	150
CAPACITÀ OLIO (IN ³) OIL TANK	9,15
RITORNO RETURN	Molla Spring
FIL. ESTERNA CILINDRO (SEC) THREAD EXT. CYLINDER	-
FIL. INTERNA CILINDRO (FIC) THREAD INT. CYLINDER	1"¼Gas Or Npt on request
DIAMETRO ESTERNO (ØE) DIAMETER EXTERNAL	55mm 2"11/64
DIAMETRO INTERNO (ØI) DIAMETER INTERNAL	45mm 1"49/64
CORSA (C) STROKE	170mm 6"11/16
FIL. ESTERNA STELO (FES) THREAD EXT. STEM	1"¼Gas Or Npt on request
FIL. INTERNA STELO (FIS) THREAD INT. STEM	-
DIAMETRO STELO (ØS) STEM DIAMETER	30mm 1"3/16
ALTEZZA CHIUSO (LC) CLOSED HEIGHT	350mm 13"25/32
ALTEZZA APERTO (LA) EXTENDED HEIGHT	520mm 20"15/32
FILETTATURA X INNESTO (FI) COUPLER THREADING	1/4"Gas Or Npt on request
PESO (KG) WEIGHT	4
PESO (LB) WEIGHT	8,82